

Crosby® Grade 100 Clevis Sling Hooks

Fatigue Rated®



QUIC-CHECK®

Crosby 8/10™

A-1339



- Forged Alloy Steel - Quenched and Tempered.
- Individually Proof Tested to 2-1/2 times the Working Load Limit with certification.
- Each hook has a Product Identification Code (PIC) for material traceability, along with the size and the name Crosby & U.S.A. in raised letters.
- Hoist hooks incorporate two types of strategically placed markings forged into the product which address two (2) **QUIC-CHECK®** features: Deformation Indicators and Angle Indicators.
- Low profile hook tip.
- New integrated latch (S-4320/S-4339) meets the world standard for lifting.
 - Heavy duty stamped latch interlocks with the hook tip.
 - High cycle, long life spring.
 - When secured with the proper cotter pin through the hole in the tip of hook, meets the intent of OSHA Rule 1926.1431(g) for personnel lifting.
- Suitable for use with Grade 100 and Grade 80 chain.
- Fatigue rated at 1-1/2 times the Working Load Limit at 20,000 cycles.
- "Look for the Platinum Color - Crosby Grade 100 Alloy Products."
- Meets the performance requirements of EN1677-2:2007 when assembled with a latch.

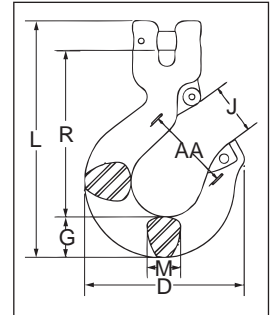

A-1339 Clevis Sling Hook

Chain Size		Working Load Limit (t)*	Hook ID Code	A-1339 Stock No.	L-1339 Stock No.	Weight Each (kg)	Dimensions (mm)							S-4320 Rep. Latch Stock No.	S-4339 Rep. Latch Stock No.
(in.)	(mm)						D	G	J	L	M	R	AA		
-	6	1.5	DA	1048982	1049103	0.29	72.6	18.5	23.6	107	16.0	74.9	38.1	1096325	-
1/4	7	2.0	HA	1048991	1049112	0.72	98.0	26.4	30.2	144	19.1	101	50.8	1096468	-
5/16	8	2.6	HA	1049000	1049121	0.71	98.0	26.4	30.2	144	19.1	100	50.8	1096468	-
3/8	10	4.0	IA	1049009	1049130	1.17	111	30.2	38.9	171	25.4	120	63.5	1096515	-
1/2	13	6.8	JA	1049018	1049149	2.39	142	36.6	45.2	213	29.7	150	76.2	1096562	-
5/8	16	10.3	KA	1049027	1049158	4.45	172	48.0	61.2	259	36.6	177	102	1096609	-
3/4	18-20	16.0	-	1049036	1049167	8.30	211	71.9	68.3	332	50.0	203	114	-	1048714
7/8**	22-23**	21.0	-	1049045	1049176	11.2	233	78.0	77.5	355	50.0	223	127	-	1048732

* Ultimate Load is 4 times the Working Load Limit.

** 7/8 in. (22-23 mm) size does not have cam, latch attaches to unique pin.