

▼ Shown: SQD-50-I



Lightweight Aluminum High-Power Wrench for Sockets or Allen Drives

- Very high torque-to-weight ratio
- High speed, double-acting operation
- High degree of rotation angle for increased productivity
- Never-jam mechanism
- High repeatability, with accuracy $\pm 3\%$
- Slim nose radius and 360° swivel hose connection allow easier positioning in confined areas
- Few moving parts means durability and low maintenance
- Push-button drive release; no tools needed to reverse square or Allen drives for tightening or loosening
- Storage case (included) protects from damage, water and dirt
- Lock-ring couplers are standard on all torque wrenches, pumps and hoses



Swivel Hose Connection

All Enerpac torque wrenches feature a 360° swivel connection to allow easy access in all positions.



Twin 3.5:1 Safety Hoses

Use only Enerpac THC-700 series twin 3.5:1 safety hoses with SQD double-acting wrenches to ensure the integrity of your system.

www.enerpac.com



Optional Allen Drives

Expanded versatility with a wide range of metric and imperial Allen drives.

Page: 26



◀ Easy and reliable service in the field using Enerpac SQD-series torque wrenches.

Double-Acting, Square Drive Wrenches



▲ All wrenches come standard with swivel coupler, square drive and reaction arm.

SQD Series



Maximum Torque:
19,875 Ft.lbs

Square Drive Range:
3/4-2 1/2 inches

Maximum Operating Pressure:
11,600 psi



Use only heavy-duty Impact Sockets for power driven torquing equipment, according to ISO 2725 and ISO 1174; DIN 3129 and DIN 3121 or ASME-B107.2/1995.



Torque Wrench Pumps

Enerpac system matched air and electric torque wrench pumps provide control to operate hydraulic torque wrenches.

Page: 32



Hexagon Bolt and Nut Sizes

See the table for hexagon sizes of bolts, nuts and related thread diameters.

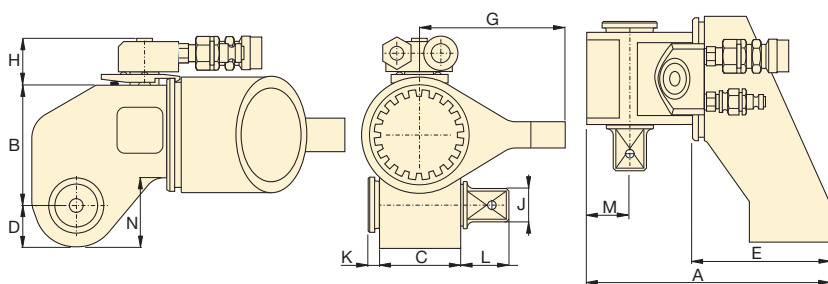
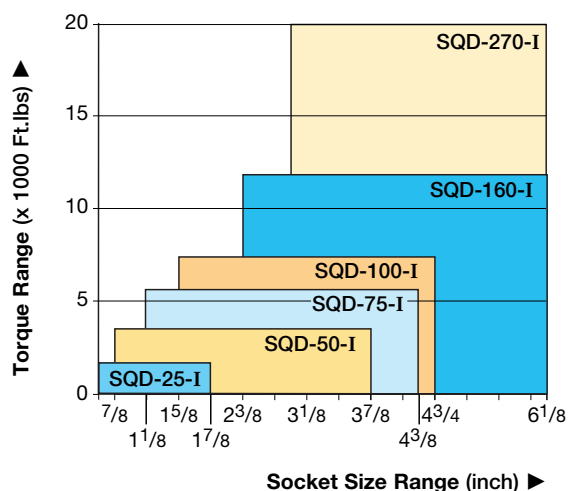

Page: 70

TORQUE WRENCH SELECTION (based on socket size range)

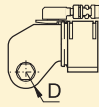

Square Drive (in)	Max. Torque @ 11,600 psi		Torque Wrench Model No.	Dimensions												Weight (incl. reaction arm and square drive) (lbs)
	(Ft.lbs)	(Nm)		A	B	C	D	E	G	H	J	K	L	M	N	
3/4	1735	2350	SQD-25-I	6.57	2.83	2.09	.94	4.25	3.74	1.38	3/4	.24	1.08	1.04	1.44	5.52
1	3550	4800	SQD-50-I	8.05	3.62	2.67	1.22	5.31	4.53	1.38	1	.59	1.30	1.34	2.07	9.35
1 1/2	5570	7560	SQD-75-I	8.89	4.21	2.95	1.41	6.02	4.80	1.38	1 1/2	.47	1.69	1.54	2.52	11.90
1 1/2	7360	10,000	SQD-100-I	9.96	4.53	3.31	1.54	6.46	5.12	1.38	1 1/2	.50	1.55	1.69	2.68	17.64
1 1/2	11,835	16,000	SQD-160-I	10.71	5.28	3.94	1.89	7.00	5.91	1.97	1 1/2	.44	1.76	2.13	3.21	26.55
2 1/2	19,875	27,000	SQD-270-I	13.45	6.46	4.69	2.32	8.58	7.87	1.97	2 1/2	.69	2.97	2.48	3.90	54.00

▼ SELECTION CHART

TORQUE WRENCH		OPTIONAL ALLEN DRIVES, IMPERIAL			REACTION ARM FOR ALLEN DRIVE
					
Model Number (max. capacity)	Nose Radius D (in)	Hexagon Size (in)	Maximum Torque ¹⁾ (Ft.lbs)	Model Number	Model Number
SQD-25-I (1735 Ft.lbs)	0.94	1/2	390	25A-050	RAH-25
		5/8	735	25A-063	
		3/4	1325	25A-075	
		7/8	1735	25A-088	
		1	1735	25A-100	
SQD-50-I (3550 Ft.lbs)	1.22	5/8	735	50A-063	RAH-50
		3/4	1325	50A-075	
		7/8	2065	50A-088	
		1	3095	50A-100	
		1 1/8	3550	50A-113	
		1 1/4	3550	50A-125	
		-	-	-	
SQD-75-I (5570 Ft.lbs)	1.41	5/8	735	75A-063	RAH-75
		3/4	1325	75A-075	
		7/8	2065	75A-088	
		1	3095	75A-100	
		1 1/8	4350	75A-113	
		1 1/4	5570	75A-125	
SQD-100-I (7360 Ft.lbs)	1.54	7/8	2065	100A-088	RAH-100
		1	3095	100A-100	
		1 1/8	4350	100A-113	
		1 1/4	6270	100A-125	
		1 3/8	7360	100A-138	
		1 1/2	7360	100A-150	
SQD-160-I (11,835 Ft.lbs)	1.89	1 1/4	6270	160A-125	RAH-160
		1 3/8	7745	160A-138	
		1 1/2	10,325	160A-150	
		1 5/8	11,835	160A-163	
		1 3/4	11,835	160A-175	
SQD-270-I (19,875 Ft.lbs)	2.32	1 1/2	10,325	270A-150	RAH-270
		1 5/8	13,275	270A-163	
		1 3/4	16,225	270A-175	
		1 7/8	19,875	270A-188	
		2	19,875	270A-200	
		2 1/4	19,875	270A-225	
		-	-	-	
		-	-	-	

¹⁾ Determine maximum torque according to the bolt size and grade.

For SQD Series



Maximum Torque at 11,600 psi:

19,875 Ft.lbs

Allen Drive Range:

1/2-2 1/4 inches

Nose Radius:

0.94-2.32 inches



Torque Wrench Pumps

Enerpac system matched air and electric torque wrench pumps provide control to operate hydraulic torque wrenches.

Page: 32



Nut Cutters / Nut Splitters

Remove rusted or corroded nuts easily with Enerpac Nut Cutters. Hexagon nut capacities up to 5.38 in.

Page: 55



Hexagon Bolt and Nut Sizes



See the table for hexagon sizes of bolts, nuts and related thread diameters.

Page: 70

▼ SQD-100-I with RAH-100 Reaction Arm and Allen drive used for loosening hexagon socket head cap screws.

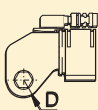

▼ SELECTION CHART

TORQUE WRENCH		OPTIONAL ALLEN DRIVES, METRIC			REACTION ARM FOR ALLEN DRIVE
					
Model Number (max. capacity)	Nose Radius D (in)	Hexagon Size (mm)	Maximum Torque (Ft.lbs)	Model Number	Model Number
SQD-25-I (1735 Ft.lbs)	0.94	14	550	25A-14	RAH-25
		17	955	25A-17	
		19	1325	25A-19	
		22	1735	25A-22	
		24	1735	25A-24	
SQD-50-I (3550 Ft.lbs)	1.22	17	955	50A-17	RAH-50
		19	1325	50A-19	
		22	2065	50A-22	
		24	2580	50A-24	
		27	3550	50A-27	
		30	3550	50A-30	
		32	3550	50A-32	
SQD-75-I (5570 Ft.lbs)	1.41	17	955	75A-17	RAH-75
		19	1325	75A-19	
		22	2065	75A-22	
		24	2580	75A-24	
		27	3685	75A-27	
		30	5160	75A-30	
		32	5570	75A-32	
SQD-100-I (7360 Ft.lbs)	1.54	22	2065	100A-22	RAH-100
		24	2580	100A-24	
		27	3685	100A-27	
		30	5160	100A-30	
		32	6270	100A-32	
		36	7360	100A-36	
SQD-160-I (11,835 Ft.lbs)	1.89	30	5160	160A-30	RAH-160
		32	6270	160A-32	
		36	8850	160A-36	
		41	11,835	160A-41	
		46	11,835	160A-46	
SQD-270-I (19,875 Ft.lbs)	2.32	36	8850	270A-36	RAH-270
		41	13,275	270A-41	
		46	18,440	270A-46	
		50	19,875	270A-50	
		55	19,875	270A-55	
		60	19,875	270A-60	
		65	19,875	270A-65	
		70	19,875	270A-70	

For
SQD
Series



Maximum Torque at 11,600 psi:

19,875 Ft.lbs

Allen Drive Range:

14-70 mm

Nose Radius:

0.94-2.32 inches



Optional Allen Drives and Reaction Arm

The **RAH**-Reaction Arm for Allen drives must be used instead of reaction arm for square drives.



Flange Spreaders

Separates pipe flanges with ease, enabling efficient maintenance tasks.

Page: 58



Select the Right Torque

Choose your Enerpac Torque Wrench using the loosening torque rule of thumb:

Loosening torque may require 250% of tightening torque depending on the condition of the fastener.

▼ SQD-50-I with 50A-22 Allen drive with RAH-50 Reaction Arm for Allen drives.

