

Crosby® Grade 100 Clevis Grab Hooks

Fatigue Rated®

"QT"
QUENCHED & TEMPERED

Crosby 8/10™



Para Español: www.thecrosbygroup.com

**SEE APPLICATION AND
WARNING INFORMATION**

On Page 258

A-1338

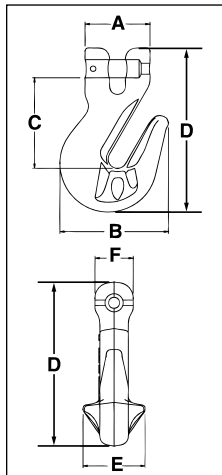

- Forged Alloy Steel - Quenched and Tempered.
- Innovative cradle design allows for 100% efficiency of Grade 100 chain.
- Individually Proof Tested to 2-1/2 times the Working Load Limit with certification.
- Each hook has a Product Identification Code (PIC) for material traceability, along with the size and the name Crosby & U.S.A. in raised letters.
- Suitable for use with Grade 100 and Grade 80 chain.
- The use of A-1338 Cradle Grab Hook will allow 100 percent of the chain sling capacity. When used to hook back to chain leg to form a choker, the angle of the choke must be 120 degrees or greater. When used as a chain shortener, minimize twist of chain and ensure chain is fully engaged in hook.
- Fatigue rated at 1-1/2 times the Working Load Limit at 20,000 cycles.
- "Look for the Platinum Color - Crosby Grade 100 Alloy Products."

A/L-1338 Cradle Grab Hook

Chain Size		Working Load Limit (lbs.)*	A-1338 Stock No.	L-1338 Stock No.	Weight Each (lbs.)	Dimensions (in.)						S-4338 Replacement Latch Kit Stock No.
(in.)	(mm)					A	B	C	D	E	F	
1/4	7	4300	1049417	1049480	.45	1.72	2.54	2.20	3.88	1.50	.88	1048426
5/16	8	5700	1049426	1049489	.99	1.72	2.54	2.18	3.88	1.50	.88	1048426
3/8	10	8800	1049435	1049498	1.80	1.85	3.09	2.58	4.69	1.83	1.09	1048435
1/2	13	15000	1049444	1049507	3.92	2.39	3.83	3.28	5.88	2.25	1.42	1048444
5/8	16	22600	1049453	1049516	7.00	2.67	4.52	3.85	7.03	2.94	1.75	1048453

* Ultimate Load is 4 times the Working Load Limit.

L-1338

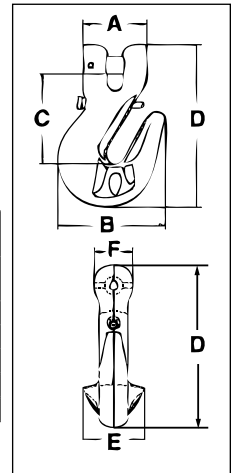

Fatigue Rated®

"QT"
QUENCHED & TEMPERED

Crosby 8/10™

A-1358

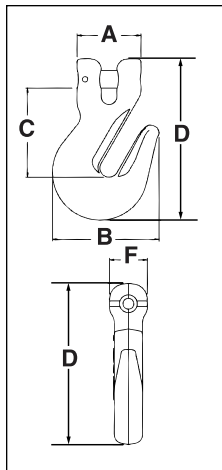

- Forged Alloy Steel - Quenched and Tempered.
- Individually Proof Tested to 2-1/2 times the Working Load Limit with certification.
- Each hook has a Product Identification Code (PIC) for material traceability, along with the size and the name Crosby & U.S.A. in raised letters.
- Suitable for use with Grade 100 and Grade 80 chain.
- Fatigue rated at 1-1/2 times the Working Load Limit at 20,000 cycles.
- "Look for the Platinum Color - Crosby Grade 100 Alloy Products."

A/L-1358 Grab Hook

Chain Size		Working Load Limit (lbs.)*	A-1358 Stock No.	L-1358 Stock No.	Weight Each (lbs.)	Dimensions (in.)						S-4338 Replacement Latch Kit Stock No.
(in.)	(mm)					A	B	C	D	F		
1/4	7	4300	1049610	1049605	1.00	1.72	2.54	2.20	3.88	.88		1048426
5/16	8	5700	1049629	1049614	.99	1.72	2.54	2.18	3.88	.88		1048426
3/8	10	8800	1049638	1049623	1.80	1.85	3.09	2.58	4.69	1.09		1048435
1/2	13	15000	1049647	1049634	3.92	2.39	3.83	3.28	5.88	1.42		1048444
5/8	16	22600	1049656	1049643	7.00	2.67	4.52	3.85	7.03	1.75		1048453

* Ultimate Load is 4 times the Working Load Limit.

L-1358

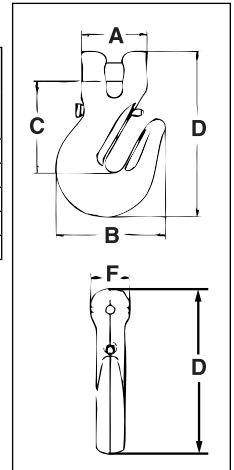

Chain & Accessories